

PRESCOTT PLAZA

300 PIONEER RD
Spruce Grove, Alberta T7X0A7

North East Corner of Pioneer Road & Grove Drive
Spruce Grove, AB

Land for Sale / Lease or Build to Suit



PROPERTY HIGHLIGHTS:

LAND FOR SALE / LEASE OR BUILD TO SUIT. 2.15 Acres of Prime Land (C-3 Zoning) Located in Spruce Groves Newest & Upcoming Modern & Contemporary Neighbourhood of Fenwyck. Proudly developed by Landrex. Opposite Wagner National Area - a 620 Acre Provincial Park. Close to Walking Trails and Ponds with a natural nature backdrop. Direct Access off Highway 16A onto Pioneer Road. **Purchase the Land or Lease Option Available at \$22/sq.ft. + CAC Costs. Purchase Units at \$350/sq.ft.**

Excellent for Retail/Professional/Office Use. Spruce Grove has a population of approx. 32,000 and average household income of \$120,206 (2017). Only an 11 minute drive to Edmonton. Taxes to be assessed.

\$1,827,500

MLS®: E4172678

300 PIONEER RD
Spruce Grove, Alberta T7X0A7

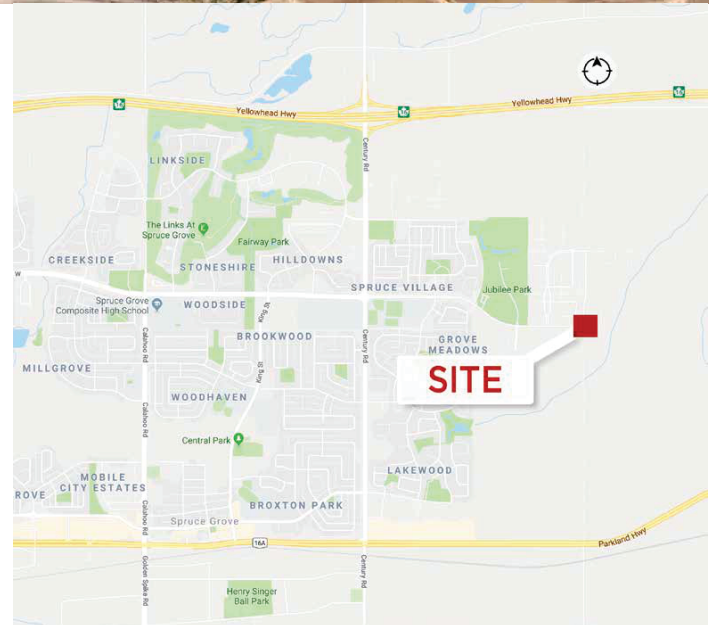

Maxwell Polaris-Commercial
4107 99 Street
Edmonton, AB T6E 3N4
Office: 780-450-6300

ROMI SARNA

780-450-6300

romi@romisarna.ca
www.romisarna.ca

Information, though deemed to be correct, is not guaranteed. Not intended to interfere with Clients under contract.

PRESCOTT PLAZA

300 PIONEER RD
Spruce Grove, Alberta T7X0A7

North East Corner of Pioneer Road & Grove Drive
Spruce Grove, AB

Land for Sale / Lease or Build to Suit



Proposed Site Plan

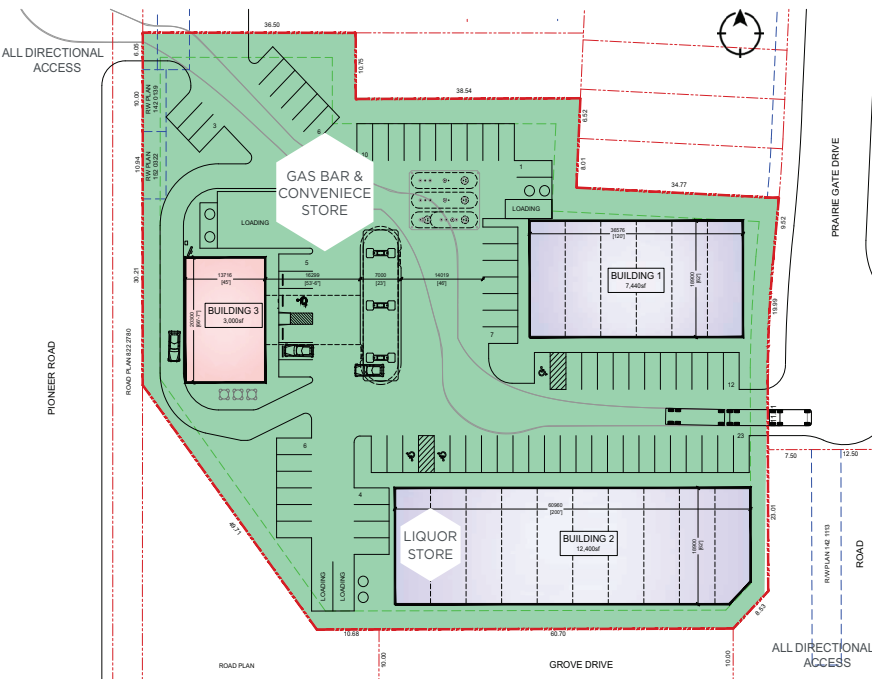

Maxwell Polaris-Commercial
4107 99 Street
Edmonton, AB T6E 3N4
Office: 780-450-6300

ROMI SARNA

780-450-6300

romi@romisarna.ca
www.romisarna.ca

Information, though deemed to be correct, is not guaranteed. Not intended to interfere with Clients under contract.